

YOUR BIN COLLECTION CALENDAR 2020

To check your collection day, visit jointwastesolutions.org

January

M	T	W	T	F
		1	2	3
6	7	8	9	10
13	14	15	16	17
20	21	22	23	24
27	28	29	30	31

February

M	T	W	T	F
3	4	5	6	7
10	11	12	13	14
17	18	19	20	21
24	25	26	27	28

March

M	T	W	T	F
2	3	4	5	6
9	10	11	12	13
16	17	18	19	20
23	24	25	26	27
30	31			

April

M	T	W	T	F
		1	2	3
6	7	8	9	10
13	14	15	16	17
20	21	22	23	24
27	28	29	30	

May

M	T	W	T	F
				1
4	5	6	7	8
11	12	13	14	15
18	19	20	21	22
25	26	27	28	29

June

M	T	W	T	F
1	2	3	4	5
8	9	10	11	12
15	16	17	18	19
22	23	24	25	26
29	30			

July

M	T	W	T	F
		1	2	3
6	7	8	9	10
13	14	15	16	17
20	21	22	23	24
27	28	29	30	31

August

M	T	W	T	F
3	4	5	6	7
10	11	12	13	14
17	18	19	20	21
24	25	26	27	28
31				

September

M	T	W	T	F
	1	2	3	4
7	8	9	10	11
14	15	16	17	18
21	22	23	24	25
28	29	30		

October

M	T	W	T	F
			1	2
5	6	7	8	9
12	13	14	15	16
19	20	21	22	23
26	27	28	29	30

November

M	T	W	T	F
2	3	4	5	6
9	10	11	12	13
16	17	18	19	20
23	24	25	26	27
30				

December

M	T	W	T	F
	1	2	3	4
7	8	9	10	11
14	15	16	17	18
21	22	23	24	25
28	29	30	31	

RECYCLING COLLECTION WEEK

- Recycling bin – please rinse and recycle items loose
- Outside food waste bin
- One plastic carrier bag of textiles
- One plastic carrier bag of small electricals

RUBBISH COLLECTION WEEK

- Rubbish bin
- Outside food waste bin
- One plastic carrier bag of textiles
- One plastic carrier bag of small electricals

RECYCLING BIN

Collected fortnightly.



Dry paper

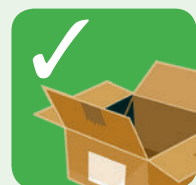

Dry cardboard



Metal tins



Metal cans



Foil



Plastic bottles



Plastic pots



Plastic tubs



Plastic trays



Glass bottles and jars

Remember

- Only put items from the above list into your recycling bin or the whole lorry load may be rejected and not recycled
- Rinse items before recycling
- Don't use bin liners or bags – recycle items loose

RUBBISH BIN

Collected fortnightly.



Plastic bags



Black bin bags



Crisp packets and wrappers



Polystyrene



Nappies



Food and drinks cartons



Tissues and wipes



Greasy pizza boxes



Coffee cups



Plant pots

WOKING

BIN COLLECTIONS AND RECYCLING GUIDE 2020

Includes calendar and Christmas 2019 dates



TEXTILES One small carrier bag is collected weekly. Can also be recycled at community recycling centres.

YES PLEASE



Clothes



Underwear



Paired shoes



Bags and belts

NO THANKS



Pillows and duvets

Remember – Items must be clean, dry and in no more than one tied carrier bag placed next to your bin.

SMALL ELECTRICALS One small carrier bag is collected weekly. Can also be recycled at community recycling centres.

YES PLEASE



Anything with a plug



Anything battery-operated



Batteries in a separate bag



Chargers

NO THANKS



Lightbulbs

Remember – Items must fit into one small tied carrier bag that is placed next to your bin. Batteries can be put into a separate small bag.

For more information on anything to do with waste or recycling, please visit jointwastesolutions.org or contact us on 03332 340978. You can also use our online search tool or app to find out what to do with an item.

FOOD BIN Collected weekly from your separate food waste bin.

YES PLEASE



All food



Meat



Eggshells

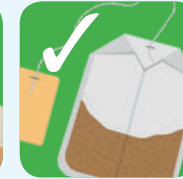

Teabags

NO THANKS



Liquids

Remember – You can line your caddy with carrier bags, vegetable bags or pedal bin liners. Please don't use black bin bags.

GARDEN WASTE Collected fortnightly. Can also be recycled at community recycling centres.

YES PLEASE



Grass cuttings



Prunings



Fallen leaves



Cut flowers

NO THANKS



Soil and stones

Remember – Subscribe to the collection service – details online. Garden waste can be composted at home – order a discounted compost bin online at surreyep.org.uk.

CHRISTMAS COLLECTIONS 2019

USUAL COLLECTION DAY

REVISED COLLECTION DAY

Monday 23 December

No change

Tuesday 24 December

No change

Wednesday 25 December

Friday 27 December

Thursday 26 December

Saturday 28 December

Friday 27 December

Monday 30 December

Monday 30 December

Tuesday 31 December

Tuesday 31 December

Thursday 2 January

Wednesday 1 January

Friday 3 January

Thursday 2 January

Saturday 4 January

Friday 3 January

Monday 6 January

Monday 6 January

Tuesday 7 January

Tuesday 7 January

Wednesday 8 January

Wednesday 8 January

Thursday 9 January

Thursday 9 January

Friday 10 January

Friday 10 January

Saturday 11 January

Collection dates over the Christmas and new year period will change as follows.

CHRISTMAS RECYCLING TIPS

Cardboard boxes

Flatten boxes to give you more space in your blue bin. Don't forget to remove any polystyrene/bubble wrap (put this in your black bin).

Wrapping paper and cards

You can recycle wrapping paper and cards, as long as they are not lined with foil or plastic, don't have glitter on and don't contain batteries.

Food waste

Don't forget you can use plastic carrier bags or liners to contain your food waste – no liquids please!

Adverse weather

If there is adverse weather during the Christmas period check website for updates.

LEAVING BINS OUT

Please make sure your bins are left on your property boundary by **6am** on your collection day.

MISSED COLLECTION?

If your bin hasn't been emptied, please report it at jointwastesolutions.org within two working days.

Thank you for recycling

Your efforts help protect the environment and save money that could be spent on essential services.

